

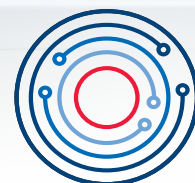

Automated IVD sample processing within your reach

Meet the most reliable match: QIAcube[®] Connect MDx and QIAamp DSP Kits

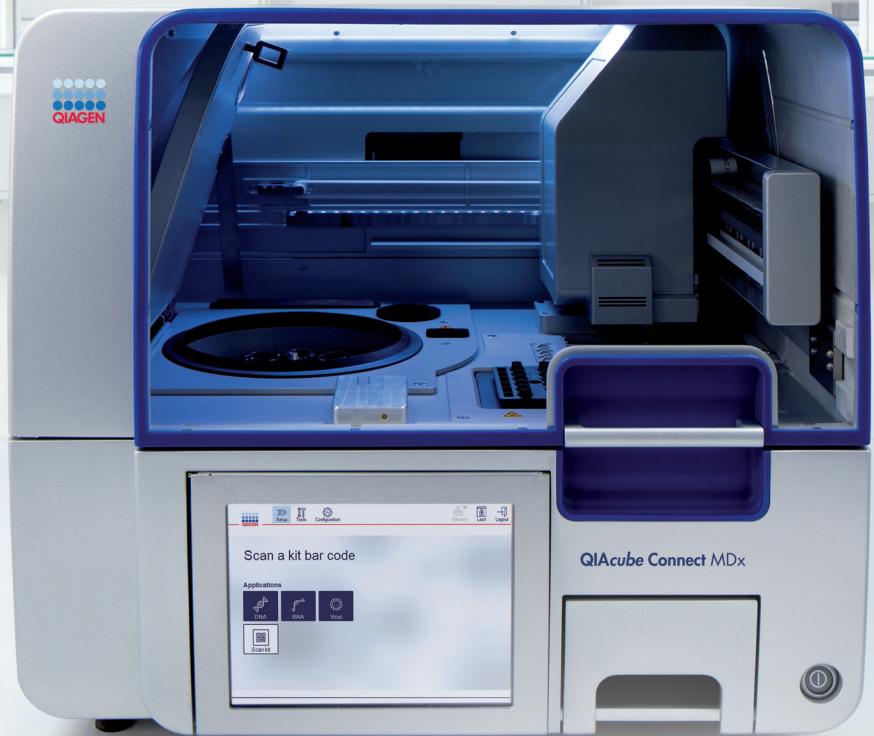

QIASphere
ready

Standardize your sample processing

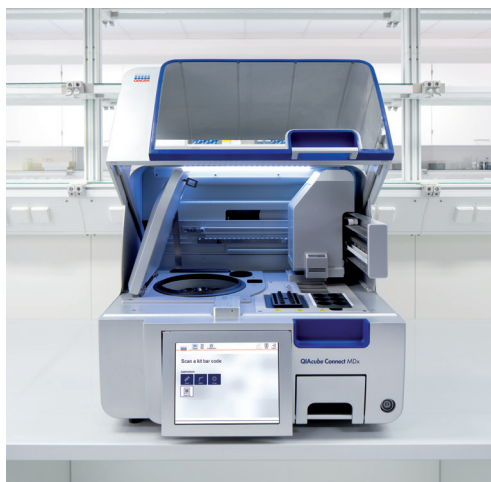

Standardize your sample processing and free yourself from repetitive manual lab work with the QIAcube Connect MDx. It offers a flexible system which automates >80 kits with over 140 standard protocols, including multiple IVD protocols. Extract pure nucleic acids for infectious disease testing, oncology, hereditary disease testing and research applications.



For more information, see our online demo at www.qiagen.com/QIAcubeConnect-demo

The QIAcube Connect MDx worktable

- 1 Centrifuge for up to twelve samples
- 2 Three tip/enzyme racks for easy loading
- 3 Sample tube holder/shaker
- 4 Bottle racks for reagents
- 5 Robotic arm with sensors
- 6 UV light for decontamination

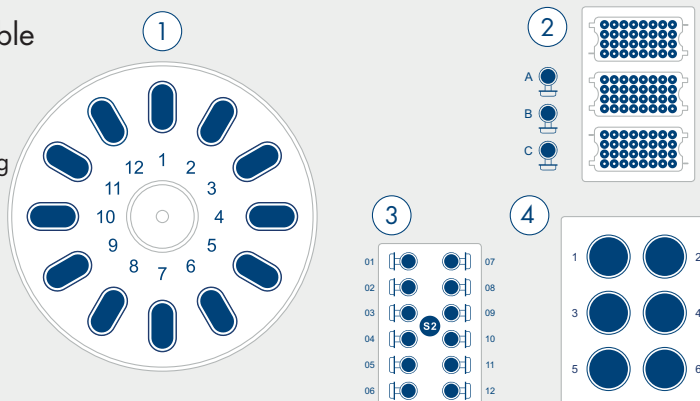

The Automation Process



Scan kit bar code and sample IDs to import data.

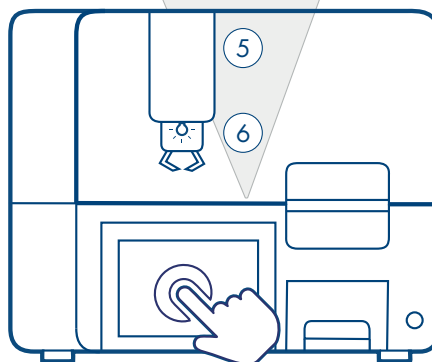

Use enhanced software for guided setup. Enjoy fully automated sample processing.



Stay connected throughout the run, with QIASphere.

Run IVD applications with ease and full confidence

Trusted QIAGEN sample preparation

QIAGEN provides a wide range of dedicated sample purification kits tailored to your needs. Our dedicated solutions for DNA and RNA sample processing deliver pure nucleic acids free of contaminants and inhibitors for use with many assay technologies.

Several sample purification kits can be automated on the QIAcube Connect MDx. The well-established QIAamp DSP Kits provide silica-based nucleic acid purification for labs processing samples for in vitro diagnostic use in infectious disease, oncology and hereditary disease testing.

The perfect combination of QIAGEN DSP extraction kits* with the QIAcube Connect MDx makes a complete IVD system that gives full confidence in your valuable results. The QIAcube Connect MDx is also equipped with a UV light to decontaminate the work deck and ensure the highest level of safety.



IVD software environment

You can now run IVD protocols in addition to research protocols on the QIAcube Connect MDx. Simply select which software environment you need before starting your protocol and follow the step-by-step instructions. The navigation in the QIAcube Connect IVD software is so intuitive that any new user will immediately feel comfortable with the system, minimizing risk for human error during set-up.

Traceability and process control

The QIAcube Connect MDx has improved run reports that show you the important information you need for your experiments, like kit expiration dates, samples' status and sample location. These detailed reports help you track samples and maintain process and quality control to meet stringent IVD requirements. Improved features for user management (e.g., password settings) and cybersecurity ensure state-of-the-art protection.

Boost your lab efficiency with QIAcube Connect MDx and QIASphere

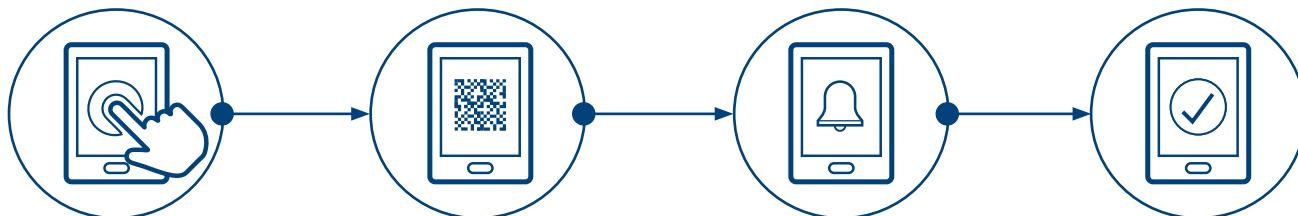

Guides run setup for research protocols at a click of a button

Scans kit bar codes and sample IDs for data import and process safety**

Provides real-time run status with push notifications for complete runs and errors

Generates reports once run is complete

Purify samples conveniently, safely, and reliably with QIAcube Connect MDx's customizable protocols, built-in UV light for decontamination, sample tracking ability, pre-run checks and remote connectivity.

| Product | Contents | Cat. no. |
|-----------------------|--|----------|
| QIAcube Connect MDx† | Instrument, connectivity package, 1-year warranty on parts and labor | 9003070 |
| Starter Pack, QIAcube | Filter-tips, 200 µl (1024); 1000 µl Filter-Tips (1024); 30 ml Reagent Bottles (12); Rotor Adapters (240); 1.5 ml Elution Tubes (240); Rotor Adapter Holder (1) | 990395 |

* For a comprehensive list of DSP Kits with protocols on the QIAcube Connect MDx, contact your local technical support department.

** Only possible for life science/molecular biology application kits-protocols.

† All configurations include a QIAcube Connect MDx robotic workstation for automated purification of DNA, RNA or proteins using QIAGEN spin-column kits, a QIASphere Base to connect to local network, a barcode reader and 1-year warranty on parts and labor.

The QIAcube Connect MDx is designed to perform automated isolation and purification of nucleic acids in molecular diagnostic and/or molecular biology applications. The system is intended for use by professional users, such as technicians and physicians trained in molecular biological techniques and the operation of the QIAcube Connect MDx system.

For up-to-date licensing information and product-specific disclaimers, see the respective QIAGEN kit handbook or user manual. QIAGEN kit handbooks and user manuals are available at www.qiagen.com or can be requested from QIAGEN Technical Services or your local distributor.

Trademarks: QIAGEN®, Sample to Insight®, QIAcube®, QIASphere® (QIAGEN Group). Registered names, trademarks, etc., used in this document, even when not specifically marked as such, may still be legally protected. PROM-17936-001 1123953 02/2021 © 2021 QIAGEN, all rights reserved.

Distributed by JANT PHARMACAL CORPORATION