

# CDS M<sup>C</sup>SERIES Hematology Analyzers



*Simple  
Accurate  
Reliable  
Economical*



Clinical Diagnostic Solutions, Inc.

# Choose The Analyzer That Best Fits Your Needs

## 3 Systems To Choose From

Open Vial Sampling System

Cap Piercing Sampling System

Autoloader Sampling System

**CDS**  
**M-SERIES**  
Hematology Analyzers



**Clinical Diagnostic Solutions** is a global company that manufactures and distributes high quality, cost effective hematology systems. Our commitment is to provide excellent products, ensuring accurate patient outcomes, safety and reliability.

### CDS M-Series

16 parameter, 3 part differential systems designed to provide fast, accurate and reliable patient results with ease.

### Patient Outcomes

High quality engineering and technology ensures system precision resulting in sample accuracy. This concept and design will reduce repeats, send outs and manual intervention.

### Simple to Use

Touch screen displays and on board step by step instruction makes operation easy. Bar coding, cap piercing and auto sampling reduce errors and ensure positive patient identification.

### Cost Effective

Saves time and money with a complete system that is virtually maintenance free. It also eliminates the need for expensive consumables for handling finger sticks and reduces the need for service support.

## What Differentiates The M-SERIES

**Accurate and Precise** — Delivers excellent patient results.

**Autoloader System** — Provides an automated cost effective solution.

**Bar Coding** — Standard with all systems giving you positive patient identification and reduces transcription errors.

**Zero Daily Maintenance** — No daily shutdown, engineered to eliminate lengthy cleaning procedures.

**Service** — Highly reliable, excellent uptime record.

**Patent Finger Stick Technology**  
20µ draw is all it takes

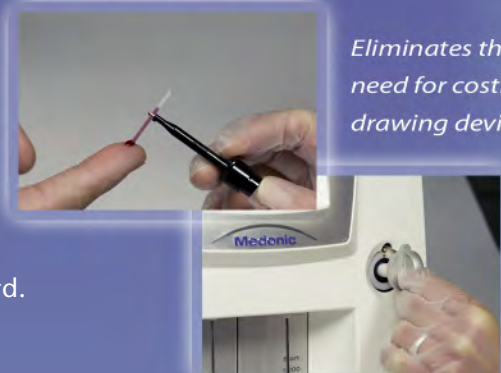

*Eliminates the need for costly drawing devices*

### Automate Your Records & Data

Integrate a Data Management Package with your system.

- Ensures compliance with all patient regulations regarding patient data, patient records, quality control and general record keeping.
- Easy to use.
- Affordable solution for the physician's office.
- Easy interface to EMR.

